

Housing Specification & Features

ETL Listed to UL 50 (Industrial Control Panel)
6063-T6 #1 Mill Finish Aluminum
Meets NEMA Requirements 1, 2, 3, 3S, 4, 4X, 5, 12 & 13
Circuit Board Slots, "T" Slots
Zytel, UL 945VA End Caps
LED Mounting Holes on End Caps (Max. 4 LED's)
3/4" End Cap Conduit Opening
Anodized or Mill Finished
Din Rail Mounting Kit

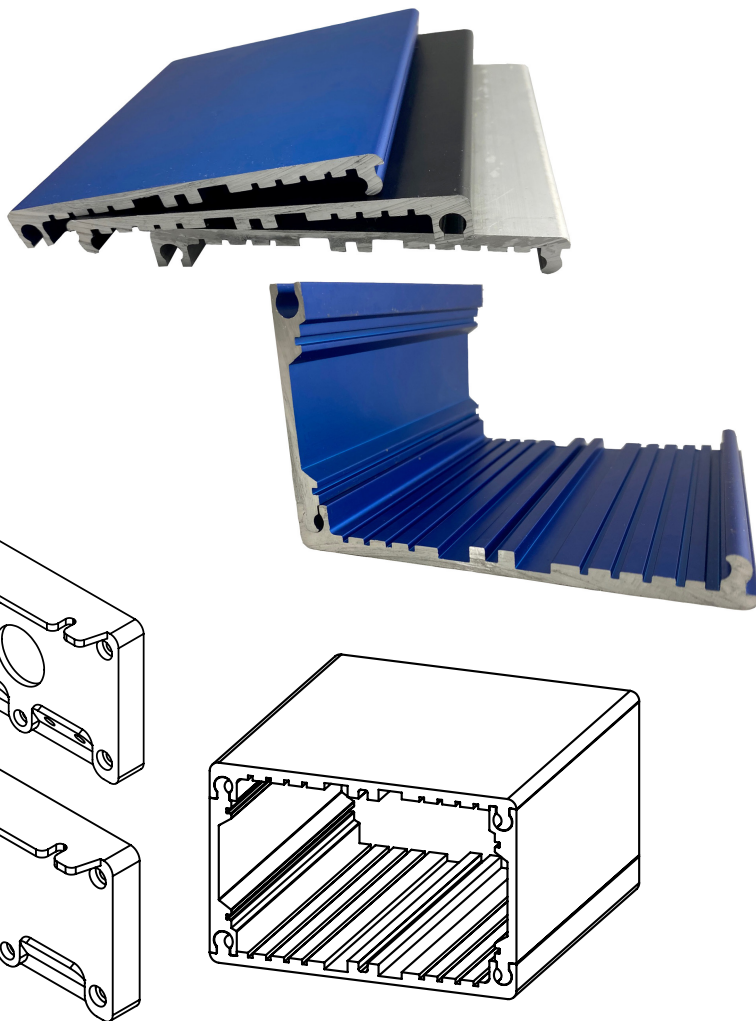

The AE Products Extruded Housings are four panel, interlocking aluminum boxes with end caps. They come equipped with circuit board slots, can be anodized in different color options and cut to lengths up to 72".

Model Number Configuration

ALM - 00 / 03 - _____

Box Finish

00 - Mill Finish
 02 - Black Anodized
 03 - Blue Anodized

Options (Multiple options allowed)

Aluminum Length

01 - 1"
 02 - 2"
 Min 1", Max 72"

End Caps

EC - End Caps

3/4" Conduit Opening

CN - Single Conduit Opening

LED Mounting Holes in End Caps

L1 - One LED Hole
 L2 - Two LED Holes
 L3 - Three LED Holes
 L4 - Four LED Holes

Din Rail Mounting Kit

DR - Din Rail Mount

Other color options and customizations available. Contact factory for details.

Note: You may add additional options as needed by extending the model number.

Enclosure Dimensions

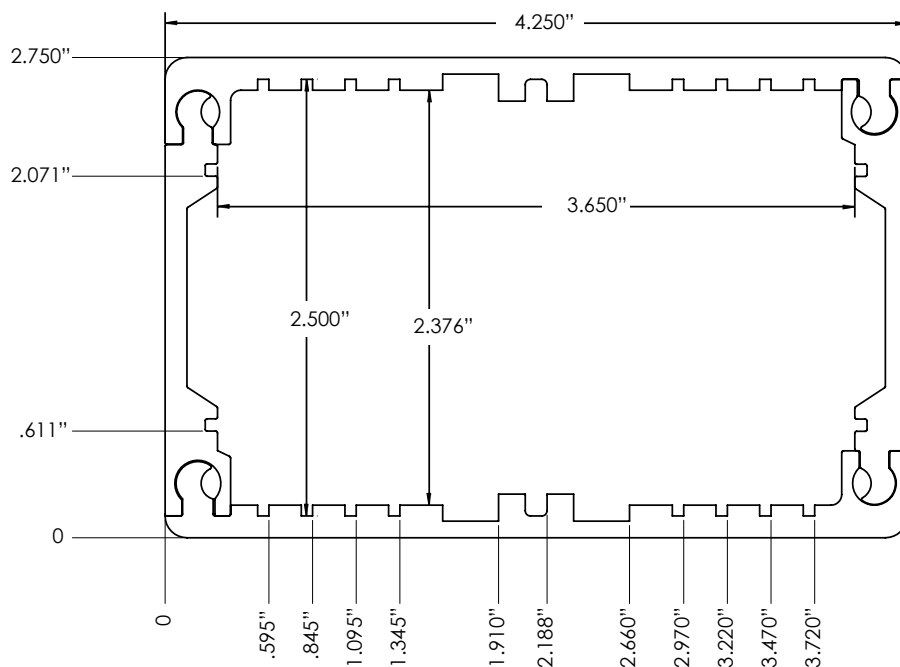

End Cap Dimensions

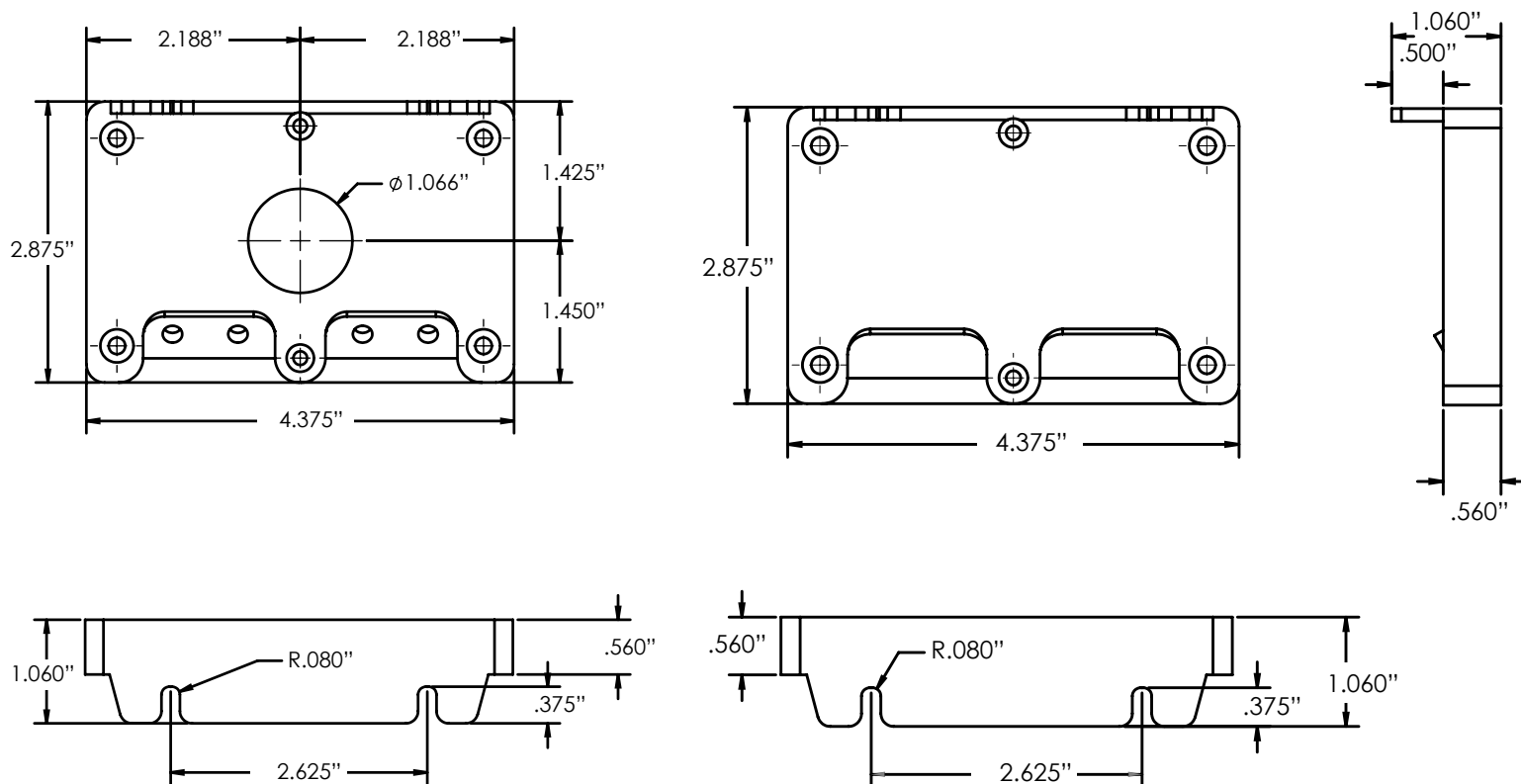

(Diagrams are not to scale)